



www.NATIONALTRAILERPARTS.com

IN THIS ISSUE

We Now Stock Mumby Hitches	2
Speedcaps Oil Cap Wrench	3
Wallace Forge Adapter	3
Poly Tongue Toolbox	3
New Website	4
New Toroflex Removable Spindle	5
Dexter Sway Control	5
Bulldog Twin Cam Dropleg Jacks	6
Bigfoot Hydraulic Jacks	6
New Faces	7
Current Catalogues	8
The Last Word	8
Contact Us	8

SELECTION SERVICE SUPPORT



Like us on Facebook

GREETINGS FROM SWIFT CURRENT!

As I write this we are about half the way through the winter of '14/'15. For the most part, the winter has been in a range from manageable to pretty darn good. By contrast to last winter; a walk in the park.

The economic conditions we face are a different story though! Our beloved Loonie is at \$.79 or so against the USD. Oil pricing is hovering at \$50 for WTI. The newscasts are shouting about fear and doom.

I refuse to buy the headlines because I am pretty sure they are wrong, or at very least overstated!

I am a perpetual optimist about life and business. I think the strong survive and the smart ones thrive in volatile times. I know we have some pretty smart customers in Western Canada so I think the next while could be a pretty exciting time.

Here is my take, bit by bit:

1. A low Canadian dollar is a very effective barrier to US based competition. I expect your phones will ring more because of this.
2. The agricultural sector (both grain and cattle) is generally in good shape with strong cash flow.
3. Energy is clearly challenged and there will most likely be more contractions in the capital spending programs for 2015. A friend of mine says "the best solution to low energy prices are low energy prices". The strong will survive.
4. The interesting thing about the trailer industry in Western Canada is the resilience of the people in it. You people! Our customers.

At National Trailer Parts our daily message is a simple one. Our task, our mission, is to help you be successful. We look forward to that opportunity every working day.

In conclusion, thank you for your business! We appreciate it very much.

All the best in 2015!



Keith Brown
General Manager
National Trailer Parts Warehouse



WE NOW STOCK MUMBY HITCHES!

The Mumby Removable Ball Gooseneck Hitch is an easy-out 2 5/16" ball hitch to pull gooseneck trailers. It simply drops through the removable safety chain attachment plate into a frame-mounted socket base where a spring-loaded pin locks the hitch in place. When you are not using your gooseneck hitch, you simply release and remove the ball and safety chain plate from inside your truck box and store it behind your seat in the tough rubberized canvas storage bag supplied. A flush fitting plug replaces the ball, keeping the receiver socket clean.

- The Mumby is the only removable ball gooseneck hitch that can be released from the inside of the truck box
- Our hitch ball simply drops through the removable safety chain attachment plate into a frame-mounted socket base
- The locking pin is spring loaded so it automatically locks when the hitch ball is installed
- Easy installation - Minimal or no drilling is required in the truck frame
- A 30,000 lbs towing capacity
- A removable safety chain and anchor plate eliminates the need for safety chain attachment devices
- The shank of the removable ball and the receiver bushing are tapered to provide easy installation and removal
- The plastic plug is designed to prevent dirt and debris from entering the open receiver bushing when the ball is not installed
- The release pin hole is drilled through the shank of the ball and both walls of the receiver bushing to allow easy access to the locking pin



A sharp looking carrying case is included with each purchase to store the hitch components in a secure dry place when not in use. NOTE: The hitch ball is NOT stored upside down leaving the receiver bushing exposed to the elements and at risk of theft.



SPEEDCAPS OIL CAP WRENCH & COUNTER DISPLAYS



- Try this inexpensive and easy-to-use wrench
- Comes in two Trailer Oil Cap sizes
- Steel AR-36 powder coated (Safety orange)
- Steel type (Grade AR-36A high strength)
- Made in the USA



Part #	Description
SC-212	Speedcaps oil cap wrench 2 1/2" Fits all caps with 2 1/2" hex head including Dexter 21-36 and Dexter 21-88 (Dexter 9K to 15K)
SC-214	Speedcaps oil cap wrench 2 1/4" Fits all caps with 2 1/4" hex head including Dexter 21-35, Dexter 21-40, and ALKO 92125 (Dexter 6K-8K, ALKO 10K-12K) Also available with free counter displays - ask you sales rep today!

WALLACE FORGE 5TH WHEEL TO GOOSENECK ADAPTER

- Easily convert your 5th Wheel to work with a gooseneck trailer
- Enjoy the benefits of a gooseneck ball without having to remove the 5th Wheel from the truck
- Standard 2 5/16" ball on one side, and a 2" kingpin on the other
- Made tough with a 30,000 lbs max weight rating to support the toughest loads



POLY TONGUE TOOLBOX

- Great low price
- Water resistant design keeps contents dry
- 3 Year manufacturer's warranty
- Durable polyethylene construction - won't rust
- Fits most A-Frame trailer tongues
- Built-in hasp for padlock



NATIONAL TRAILER PARTS NEW WEBSITE

Early last year we made the decision to put some of our budget towards revising our website. We hadn't made any significant updates for a few years, and we felt like we needed something new and fresh in order to attract new visitors and keep current ones interested and coming back.

We went to our design team over at Graphic Intentions Inc and asked them to come up with a new design for us. In our discussions with them it was clear that a major part of the redesign was going to have to be making the site responsive, meaning that the layout of the site would be customized for various viewports; desktop computer, tablet or smartphone. Whatever device you are viewing the site on, you will see all of the most vital information instantly. This is extremely important, especially when recent statistics show that 76% of Canadians are accessing the Internet via mobile devices rather than through traditional desktop computers.

We knew we wanted the site to have an updated look and style, and the GI team came up with a dynamic design that really appealed to us. The site has a clean and simple

navigation with a "story-telling" design which we thought reflected the type of company we are. From the instant you start navigating the site you are taken on a "journey" through the homepage, discovering Who We Are and Who We Serve. Other Homepage highlights include Product information and other Guides and News items we think would be valuable, along with a number of unique animations which are dynamic and engaging. It's amazing the difference high quality photos and parts images can make in creating a professional looking website.

We are really proud of the new site and we've already seen our mobile traffic double since it launched in November 2014. Please visit www.nationaltrailerparts.com and check it out for yourself! Send us an email or leave a comment on one of our social media channels. We are always eager to hear what our customers have to say!

If you want our web designer's perspective, check out GI's case study on the project: www.graphicintentions.com/ntp

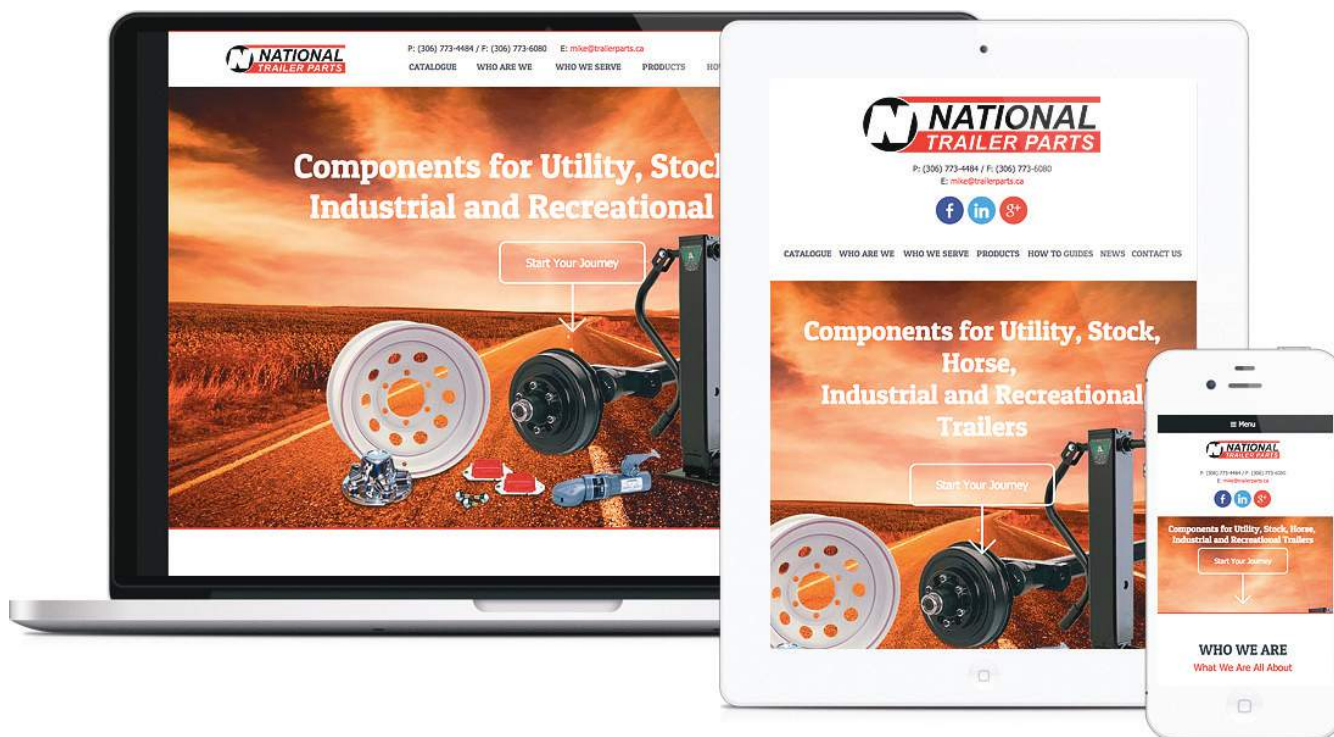

NEW TORFLEX REMOVABLE SPINDLE OPTION FROM DEXTER

The removable spindle is available on 2000 lbs, 3500 lbs, 6000 lbs and 7000 lbs Torflex axles, and features the Dexter E-Z Lube grease system.

This feature must be ordered with the axle - a very reasonably priced option at the time of ordering.

Spindle replacement kits are available in the event that a spindle is damaged - it can easily and cost effectively be replaced - eliminating the time and expense of replacing the axle.

Removal of the spindle requires no special tools. With only one stainless steel bolt to remove - the procedure is quick and easy.

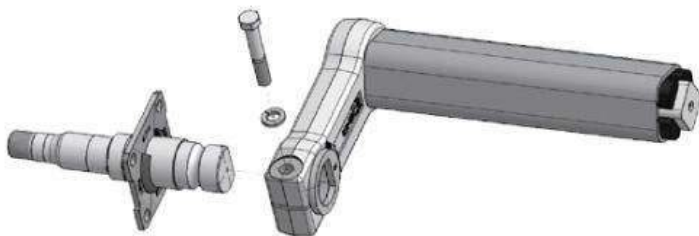

DEXTER SWAY CONTROL (DSC)

The Dexter Sway Control System is a critical safety item to stabilize the sway of your RV or Trailer. This feature is only available pre-installed by the trailer manufacturer on units with electric brakes.

The DSC system continuously monitors trailer yaw and rapidly identifies a trail sway condition. (Yaw is the side to side movement around an axis - or as it relates to a tow vehicle and trailer; the movement of a trailer that is going left to right of the tow vehicle.)

These conditions can be caused by being passed by a semi-truck & trailer, large gusts of wind, and sudden swerves to avoid hazards on the road. All of these situations can cause the trailer to sway and possibly end up losing control of the tow vehicle and trailers.

The DSC will work independent of the tow vehicle to apply the brakes in the event of sway. Depending on which way the trailer is swaying, the DSC will detect it automatically and apply the brake on the opposite side of the sway, straightening out the trailer.

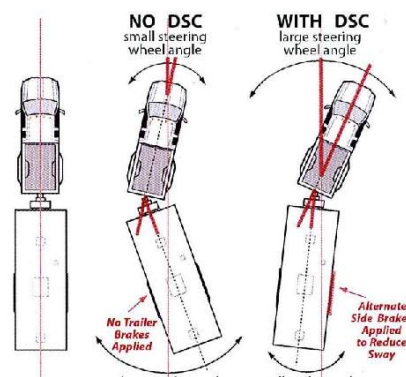

BULLDOG TWIN CAM DROPLEG JACKS

“The Industry’s Strongest Dropleg Jack”



- Heavy-duty jack is perfect for raising, leveling
- Supporting horse, livestock and other weighty trailers
- Easy-to-access grease fittings for routine maintenance
- Integrated screw stop keeps you from over-extending jack
- The Twin Cam mechanism allows an increase in the vertical static capacity (25K single, 50K tandem) by using two 3/4” pins to transfer forces between the drop leg and the inner tube of the jack
- The unique Twin Cam drop leg mechanism actuates the drop leg pins in both directions, giving the operator full control over engagement and disengagement of the drop leg pins. The design does not rely on spring pressure alone to keep the pins in the locked position
- The enclosed Twin Cam drop leg mechanism keeps dirt and debris from interfering with the engagement of the drop leg pins
- Single and Two-Speed version available; spring and non-spring legs, allowing greater flexibility for customers

Part#	Description
182700TC	Twin Cam DL Jack SW 25K, non-spring leg
182701TC	Twin Cam DL Jack SW 25K, spring leg
183719TC	Twin Cam DL Jack SW 25K, 2-spd, non-spring leg
183750TC	Twin Cam DL Jack SW 25K, 2-spd, spring leg

BIGFOOT HYDRAULIC JACKS

- The New 6K Jack and 8K A-Frame Hydraulic Jack from Bigfoot
- They are stronger, manufactured better, and made to outlast the competition
- Hydraulics allows you to quickly raise and lower the trailer
- Raise the trailer in a matter of seconds not minutes
- Easier to operate than conventional jacks. As easy as pressing a button

Part#	Description
QT8K-16	Bigfoot Jack. 8K Hydraulic A-Frame 16.5” Lift
SQ20-I	Bigfoot Jack, 6K Hydraulic 20” Lift.



NEW FACES

Lots of new faces at National Trailer Parts this year - and that brings lots of new energy. This is the first time in many years we have been at full staff. Here are a few of the faces to go with the voices at our end of the line.



ADRIEL PRUDHOMME - Delivery



DAN SAWATSKY - Warehouse



CHRIS OLENIC - Sales Department



CHRIS GREGORY - Warehouse



FALLON ROHRICH - Administration



JARED JOHNSON - Warehouse

CURRENT CATALOGUES

If you require a new printed catalogue, please contact your sales rep, and we will get one out to you right away.

If you would like access to our online catalogue, please contact Ryan Bull, ryan@trailerparts.ca

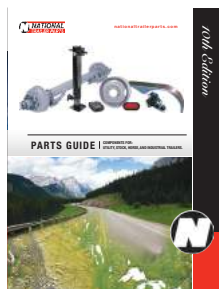

Parts Guide



Marine Catalogue



Online

THE LAST WORD

2014 was a pretty amazing year.

We had the honor of working with customers that have been with us for many years - many since the beginning of National Trailer Parts; as well as forming relationships with many new customers.

We expanded our customer base in manufacturing, having the opportunity to work on new types of equipment in new markets (new to us, anyway). We were also able to significantly expand our Stocking Dealer customers across Western Canada - from Vancouver Island right through to Thunder Bay.

The support that this industry gives us is truly humbling, I cannot thank you all enough for your business.

What will 2015 bring?

I've been told if you are going to predict - predict often and deny any previous predictions. I think this is going to be one of those years. Currency is drudging on a painful course downwards - we all know it hurts getting to a 75 or 80 cent Canadian Dollar.

But we also all know - those of us in the manufacturing sector at least - of the benefits it gives Canadian companies. As the cost of foreign made goods becomes more expensive, we are already helping our customers switch gears as demand for the more stable-priced Canadian Trailers, Canadian Rental Equipment, Canadian Recreational Vehicles and Canadian Ag Equipment increases.

The slow-down in energy generally means a thorough run-thru of everyone's equipment. We have already seen increased activity at many of our stocking parts dealers as equipment comes in off of leases and they are repaired and rebuilt in preparation for the spring season.

So - not the same - but not necessarily bad.

Opportunities are out there - lets go and get them. If you need any help getting it - give us a call.

Take Care

CONTACT US

Chris Olenic - 855.778.7306
chris@trailerparts.ca

Ryan Bull - 855.778.7303
ryan@trailerparts.ca

Doug Hall - 855.778.7302
doug@trailerparts.ca

Rick Penner - 306.741.3258
rick@trailerparts.ca

Mike Heschel - 306.773.4484
mike@trailerparts.ca



Mike Heschel
VP Sales & Marketing
Assistant General Manager
National Trailer Parts Warehouse